

C SECTION: -Y-Y'
SCALE: 1:100

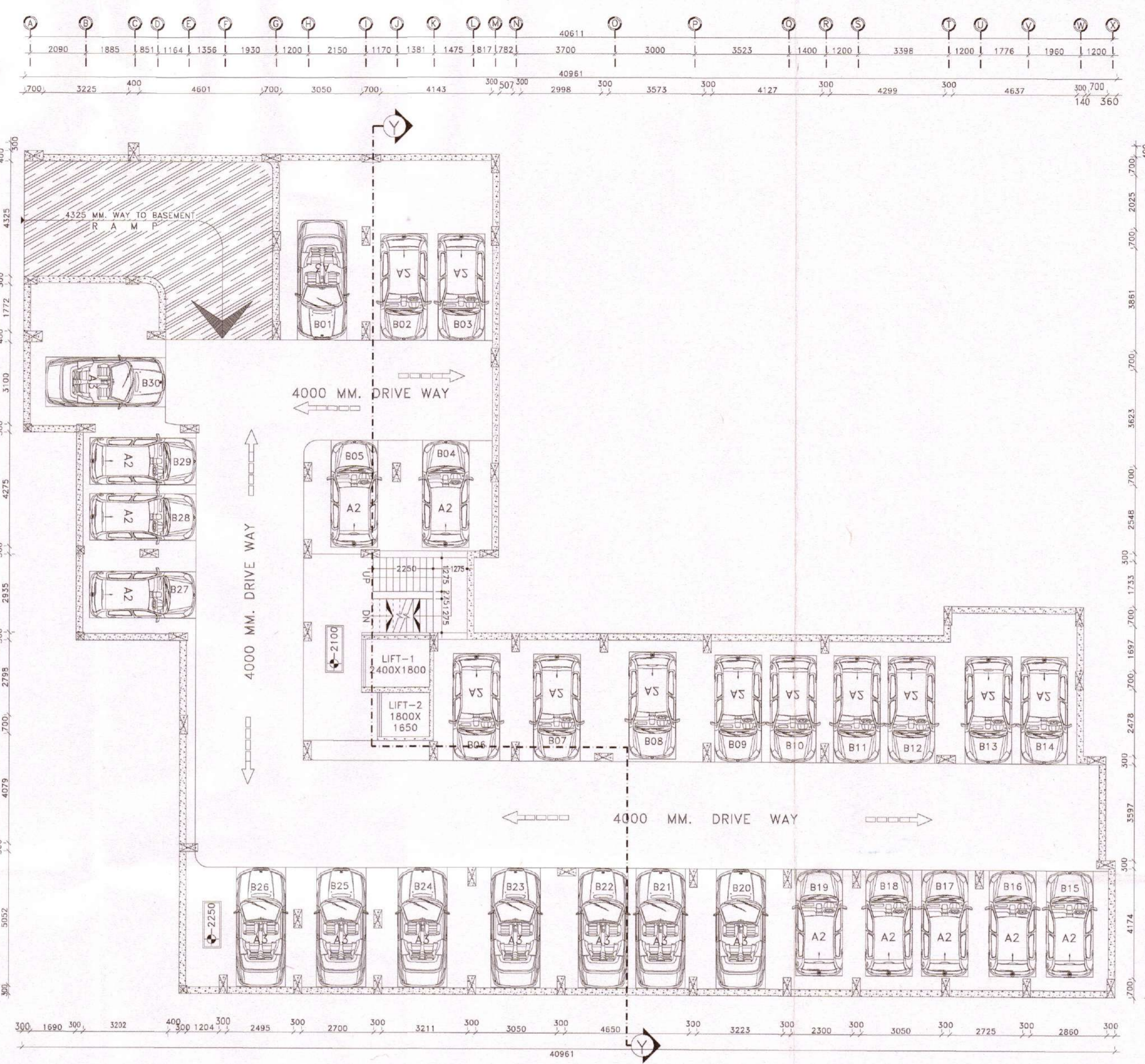

D BASEMENT FLOOR PLAN
SCALE: 1:100



E LAYOUT MAP
SCALE: 1:250

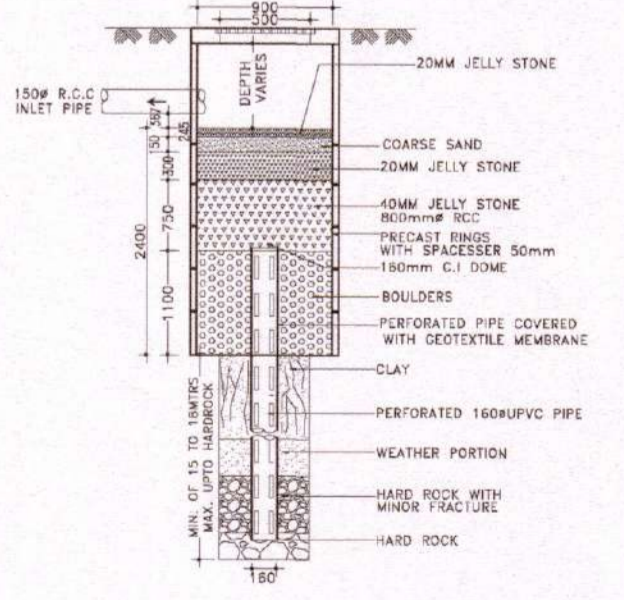

F SECTIONAL DETAILS OF RAIN WATER SOAK PIT
SCALE: N.T.S.

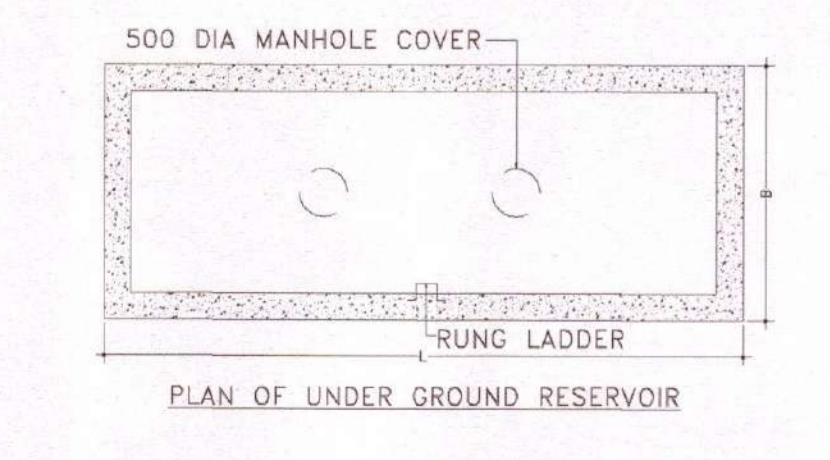
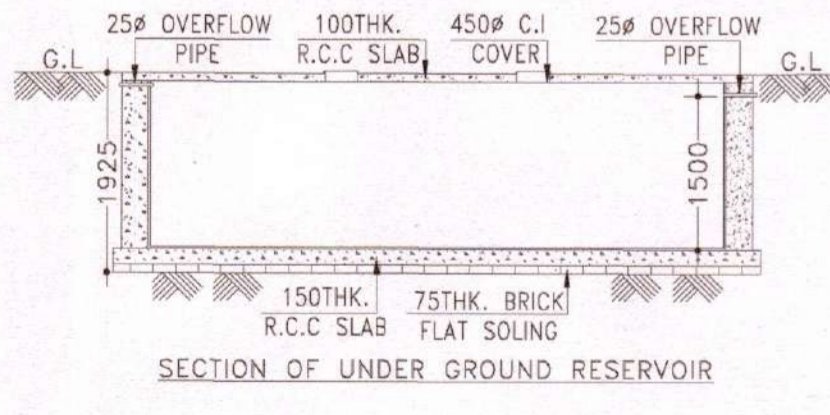

G DETAILS OF UNDER GROUND RESERVOIR
SCALE: N.T.S.

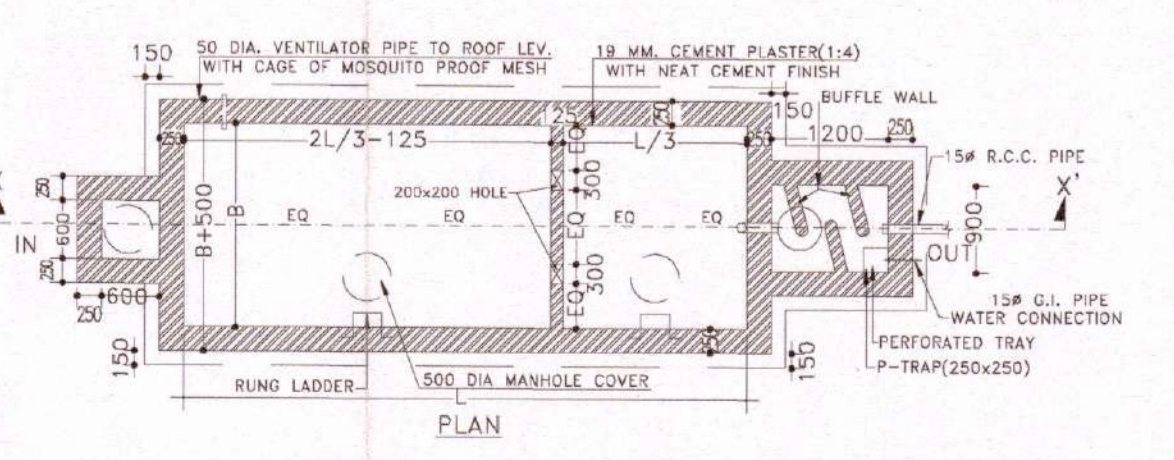
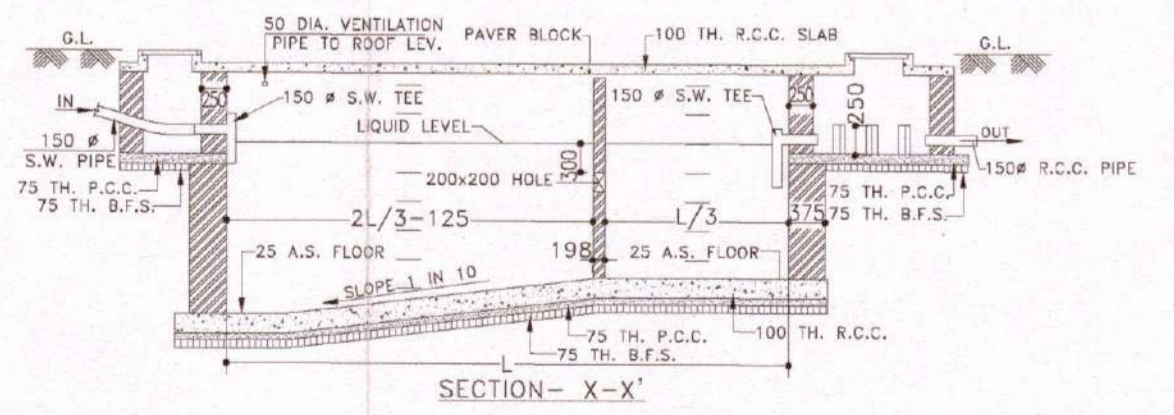

H DETAILS OF SEPTIC TANK
SCALE: N.T.S.

PROJECT NAME:
PLAN OF PROPOSED (8+G+10) STORED RESIDENTIAL CUM COMMERCIAL BUILDING OF MRS. RINA GHOSH W/O MUKTIPADA GHOSH, MR. MUKTIPADA GHOSH S/O LATE RABI LOCHAN GHOSH, MRS. SHOBHA GHOSH W/O NARAYAN CHANDRA GHOSH, MRS. CHHANDA GHOSH W/O DAMODAR GHOSH, MRS. RAJKUMARI GHOSH W/O CHANDI CHARAN GHOSH, R.S. PLOT NO- 21, 22, 23, 24, L.R. PLOT NO- 39, 52, 53, L.R. KHATAN NO- 2486, 2195, 2763, 2834, 2835, 2838, 2839. J. L. NO -109 MOUZA-SHANKARPUR, P. S - N.T.P.S., DIST-PASCHIM, BARDHAMAN, WEST BENGAL.

SCHEDULE OF DOOR & WINDOW:-

MARK	SIZE	DESCRIPTION
D1	1000X2100	FULLY PNL
D2	900X2100	FULLY PNL
D3	750X2100	FULLY PNL
W	1800X1200	SLIDING WINDOW
W1	1500X1200	SLIDING WINDOW
W2	1200X1200	SLIDING WINDOW
W4	900X1200	SLIDING WINDOW
V		VENTILATION FOR STAIR CASE
V4	600X450	LPVC MOVABLE VENTILATOR

- *** NOTES :-
1. ALL DIMENSIONS ARE IN M.M. . ROAD IS IN FT. & INCH. AND ALL LEVEL ARE IN M.
 2. WRITTEN DIMENSIONS MUST BE FOLLOWED.
 3. ALL EXTERNAL WALLS 250TH. & INTERNAL WALLS 125THK. UNLESS OTHERWISE MENTIONED.
 4. ALL MASONRY WORKS ARE BOUNDED BY CEMENT MORTAR (1:6) & (1:4).
 5. EXTERNAL PLASTER IS 25THK. & INTERNAL PLASTER IS 12MM.THK.
 6. ALL CONC. GRADE IS M25 & AND GRADE OF STEEL FE-500.
 7. 250THK. BRICK WORK IN 1:6 MORTAR.
 8. 125THK. & 75THK. BRICK WORK IN 1:4 MORTAR.
 9. 150 WIDE SURFACE DRAIN SHOULD BE PROVIDED ALL ROUND THE BUILDING.
 10. 25% OF THE BUILDING TO BE CONSTRUCTED USING FLY-ASH BRICKS.

AREA CALCULATION:-

LAND AREA	PLINTH AREA
BASEMENT FLOOR	779.61 SQ.M.
GROUND FLOOR	730.07 SQ.M.
FIRST FLOOR	761.80 SQ.M.
SECOND FLOOR	831.23 SQ.M.
THIRD FLOOR	831.23 SQ.M.
FOURTH FLOOR	831.23 SQ.M.
FIFTH FLOOR	831.23 SQ.M.
SIXTH FLOOR	831.23 SQ.M.
SEVENTH FLOOR	831.23 SQ.M.
EIGHTH FLOOR	831.23 SQ.M.
NINTH FLOOR	831.23 SQ.M.
TENTH FLOOR	831.23 SQ.M.
TOTAL	9752.55 SQ.M.

* GROUND COVERAGE = 47.14%
* F.A.R = 2.49

SIGNATURE OF DEVELOPER/OWNER:
Muktipada Ghosh
Rina Ghosh
Chhandada Ghosh

SIGNATURE OF ARCHITECT:
Manju Monowara Khatoon
MANJU MONOWARA KHATOON
ARCHITECT
CA/2022/146222
GIDS, Durgapur -16

SIGNATURE OF STRUCTURAL ENGINEER:
Hirok Ghosh
HIROK GHOSH
Structural Engineer
Lic No. L.S.P.18153/AMC-DMCI/BDP/165
DCE, B-TECH, G.I.D.S. Durgapur-16
Contact No.- 7892384157

SIGNATURE OF GEO TECHNICAL ENGINEER:
Manjushree
MANJUSHREE
GEO TECHNICAL ENGINEER
Lic No. L.S.P.M/162/AMC
G.I.D.S. Durgapur-16

TITLE:
* SECTIONAL VIEW
* BASEMENT FLOOR PLAN
* LAYOUT MAP
* SECTIONAL DETAILS OF RAIN WATER SOAK PIT
* DETAILS OF UNDER GROUND RESERVOIR
* DETAILS OF SEPTIC TANK

DRAWN BY: S.PANJA
CHECKED BY: M.KHATOON
SCALE: 1:100, 1:250, N.T.S.
REV.-00 DATE: 07.02.2023
SHEET NO: ARCH./P&RD-02/04

Approved Plan No. 177 on Meeting
No. 06/2022-23, Date 15/07/2022
Valid upto 12/10/2024
Saptasabi Sen
Pradhan 1410/24
Jermua Gram Panchayat